

- NOTES:
1. SPECIFICATIONS PER IDS-15
  2. CONTACT, FERRULE AND SPACER SHIPPED LOOSE.
  3. DESIGNED TO ACCOMMODATE RG316-DS (DOUBLE SHIELD) CABLES.
  4. CRIMP CONTACT USING DANIELS 'AFM8' CRIMPER - SETTING #1 AND 'K2159' POSITIONER.
  5. CRIMP FERRULE WITH .151 HEX DIE (M22520/5-37).
- HOUSING:** D-SUBMINIATURE, SIZE 8 CAVITY.

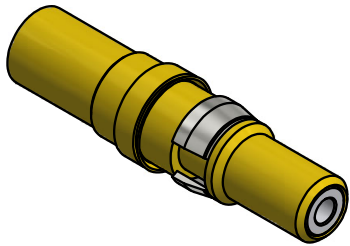

SCALE 2.5 : 1

				This drawing embodies a proprietary design of The Phoenix Company of Chicago, Inc., Naugatuck, CT 06770. All design, manufacturing, reproduction, use, sale, and other rights regarding the same are expressly reserved. The information in this drawing may be covered completely or in part by patents and/or patents pending.	WARNING - THIS DOCUMENT CONTAINS TECHNICAL DATA WHOSE EXPORT IS RESTRICTED BY THE ARMS EXPORT CONTROL ACT (TITLE 22, U.S.C., SEC 2751, ET. SEQ.) OR THE EXPORT ADMINISTRATION ACT OF 1979, AS AMENDED, TITLE 50, U.S.C., APP 2401 ET SEQ. VIOLATIONS OF THESE EXPORT LAWS ARE SUBJECT TO SEVERE CRIMINAL PENALTIES. DISSEMINATE IN ACCORDANCE WITH PROVISIONS OF DOD DIRECTIVE 5230.25.	Filename: B_C_Size_Formats.idw			<i>The <b>PHOENIX</b> Company of Chicago, Inc.</i>				
<div>UNLESS OTHERWISE SPECIFIED, PHOENIX WORKMANSHIP STANDARDS APPLY DIMENSIONS IN INCHES OR (METRIC)</div> <div>DO NOT SCALE PRINTS</div> <div>TOLERANCES ARE: FRACTIONS: ± 1/64 DECIMALS: .XX ± .01 .XXX ± .003 ANGLES: ± 1/2°  32√</div>			APPROVALS			DATE		TITLE  <div>PDM PLUG, DOUBLE-CRIMP TERMINATION</div>					
			DRAWN EY			5/20/1998							
			CHECKED HN			5/20/1998							
			QA										
			MFG										
			ENGINEER EY			5/20/1998		SIZE B	FSCM 58167	DWG NO <b>15-0090-2670</b>			REV D
APPROVED HN		5/20/1998		SCALE 4 : 1		F.S.R. #			SHEET 1 OF 1				