

CABLE

PKZ ASSEMBLY

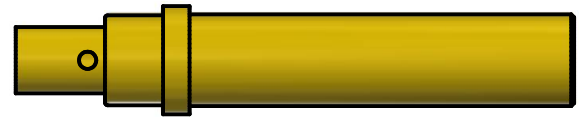

Step 1 (for Flex style cable only)
Dip end of cable into flux and then tip dip cable to $.30 \pm .02$ into solder pot for 3 second max.

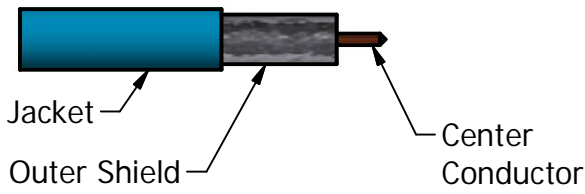
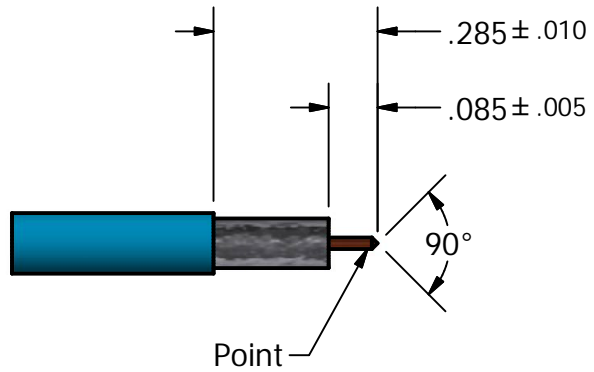

Step 2
Trim cable to dimensions shown, ($.285 \pm .010$ dimension for jacketed cables only). Point center conductor. Check center conductor for straightness.

Step 3
Install cable into body until cable bottoms in body. Solder body to cable as shown. Clean solder joint.

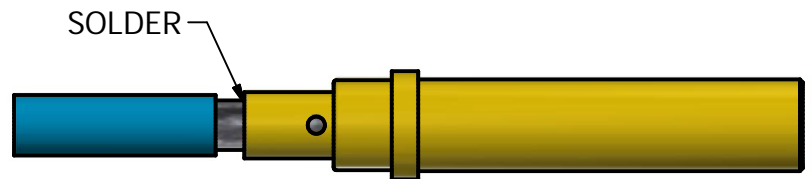

CAD DRAWING - NO MANUAL REVISIONS
filename:h-Palco-Phoenix\Palco_A-B-C_Sizes_11-26-2018.idw

WARNING - THIS DOCUMENT CONTAINS TECHNICAL DATA WHOSE EXPORT IS RESTRICTED BY THE ARMS EXPORT CONTROL ACT (TITLE 22, U.S.C., SEC 2751, ET. SEQ.) OR THE EXPORT ADMINISTRATION ACT OF 1979, AS AMENDED, TITLE 50, U.S.C., APP 2401 ET SEQ. VIOLATIONS OF THESE EXPORT LAWS ARE SUBJECT TO SEVERE CRIMINAL PENALTIES. DISSEMINATE IN ACCORDANCE WITH PROVISIONS OF DOD DIRECTIVE 5230.25.

| MATERIAL: | | | | CATALOG ITEM | | APPROVALS | | DATE | The <i>PHOENIX</i> Company of Chicago TM | | | | | |
|--|-------------|------|-------|--------------|--|-----------|----------|--|---|---------------|------|--------|-----|--------------|
| <small>UNLESS OTHERWISE SPECIFIED, PHOENIX WORKMANSHIP STANDARDS APPLY. DIMENSIONS IN INCHES OR (METRIC). DO NOT SCALE PRINTS TOLERANCES ARE: FRACTIONS: ± 1/64 DECIMALS: .XX ± .01 .XXX ± .003 ANGLES: ± 1/2°</small> | | | | DRAWN | | JEM | 08/10/15 | 22 GREAT HILL RD., NAUGATUCK, CT 06770 WWW.PHOENIXOFCHICAGO.COM | | | | | | |
| | | | | CHECKED | | R.M.B | 08/10/15 | TITLE | | | | | | |
| | | | | QA | | | | CABLE ASSEMBLY PROCESS | | | | | | |
| <small>THE INFORMATION DISCLOSED IN THIS DOCUMENT IS CONFIDENTIAL AND PROPRIETARY TO PHOENIX CO. INC. AND MAY NOT BE USED FOR MANUFACTURE OR ANY OTHER PURPOSE WITHOUT THE WRITTEN CONSENT OF THE PHOENIX CO. OF CHICAGO INC.</small> | | | | MFG | | | | FOR 168-1020-0860 | | SIZE | FSCM | DWG NO | REV | PLATING OPT. |
| | | | | ENGINEER | | JEM | 08/10/15 | A | 58167 | 168-1020-0860 | G | | | |
| | | | | APPROVED | | R.M.B | 08/10/15 | SCALE | F.S.R. # | SHEET | 1 | OF | 1 | |
| REV. | DESCRIPTION | DATE | APPR. | | | | | | | | | | | |