

| | | | | | | |
|---------------------------|----------------|---|-----|---------------|----------|------|
| CABLE ASSEMBLY PROCEDURE | | PALEO CONNECTOR 22 GREAT HILL ROAD, NAUGATUCK, CT. 06770 PHONE: (203) 729-9090 FAX: (203) 723-1794 | REV | DESCRIPTION | DATE | APPR |
| P/N | 26-003X-0670 | | M | PER ECN 10109 | 12/04/09 | JEM |
| PAGE 1 OF 1 | DATE: 10/01/99 | | N | PER ECN 10297 | 04/21/10 | JEM |
| DRAWN: KJT | APPROVED: HN | | P | PER ECN 10689 | 11/08/10 | JEM |
| FOR USE WITH RG-316 CABLE | | | R | PER ECN 11004 | 06/22/11 | JEM |

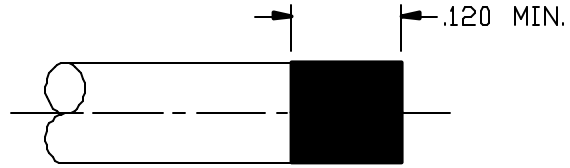

STEP 1

FLUX AND TIN DIP TO DIMENSION SHOWN.

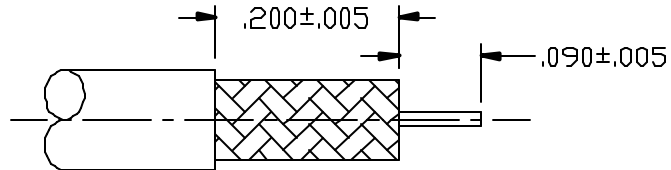

STEP 2

STRIP DIELECTRIC TO EXPOSE CENTER CONDUCTOR. STRIP OUTER JACKET TO EXPOSE BRAID. TIN CENTER CONDUCTOR.

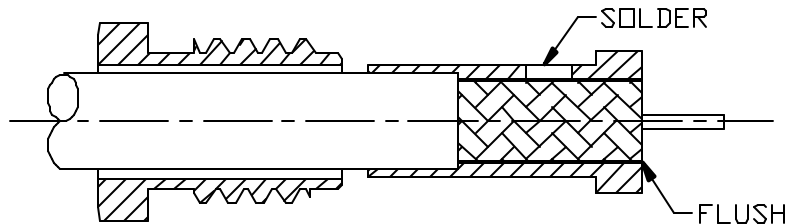

STEP 3

SLIDE CLAMP NUT AND SOLDER FERRULE OVER CABLE. SOLDER FERRULE THROUGH HOLE ON SIDE OF FERRULE. TRIM DIELECTRIC AND BRAID FLUSH TO FERRULE SURFACE IF NECESSARY.

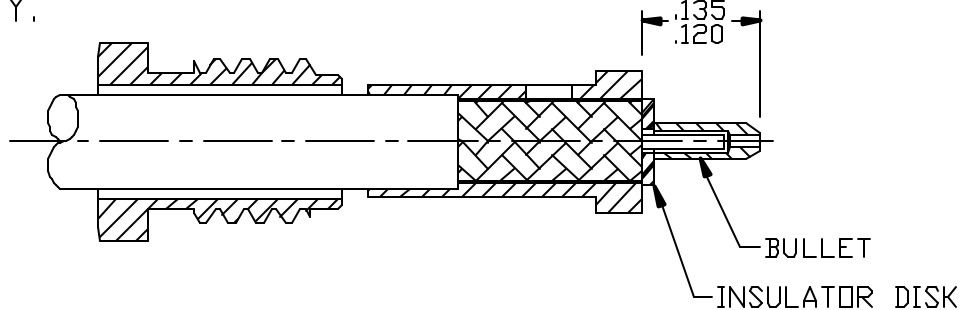

STEP 4

SLIDE INSULATOR DISK OVER CENTER CONDUCTOR. SOLDER BULLET TO CENTER CONDUCTOR. CLEAN.

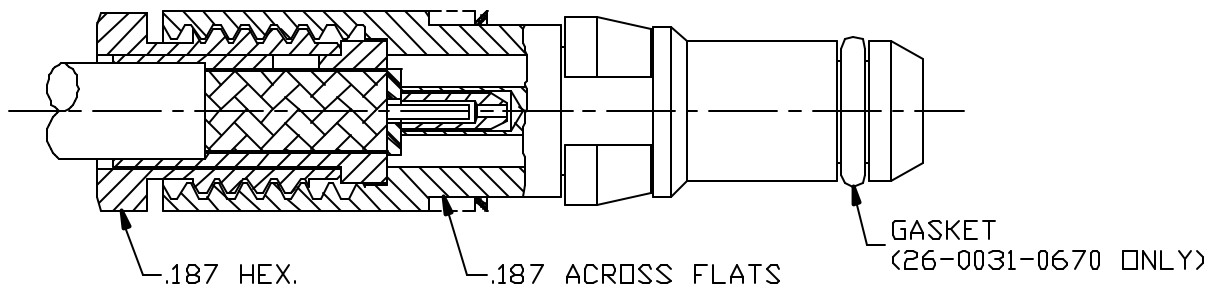

STEP 5

INSERT ASSEMBLY INTO CONNECTOR BODY. TIGHTEN CLAMP NUT TO 90-100 IN-OZS.