

Step 1
Flux and tin dip the cable, to dimension shown.

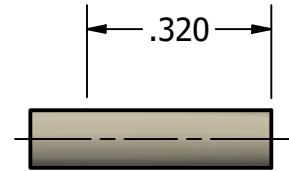

Step 2
Trim cable to the dimensions shown.

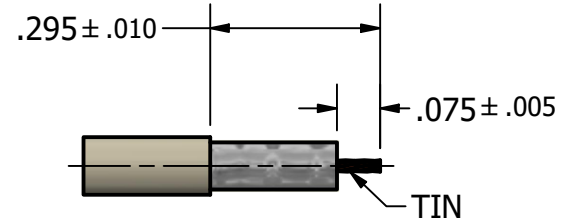

Step 3
Slide clamp nut and solder ferrule onto cable (slightly twisting). Set front shoulder of solder ferrule flush with cable and solder. Clean solder joint.

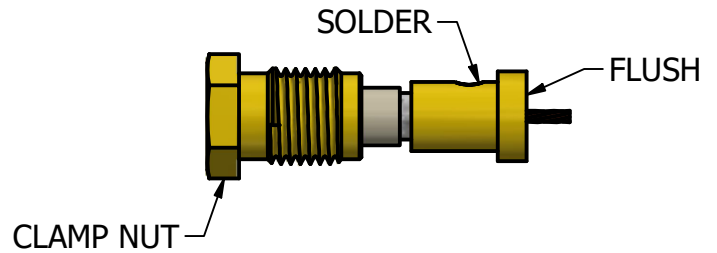

Step 4
Slide spacer and bullet over center conductor of cable. Solder bullet to cable. Clean solder joint

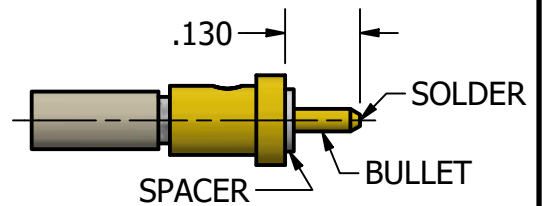

Step 5
Insert cable assembly into body and tighten clamp nut to 90-100 in-ozs

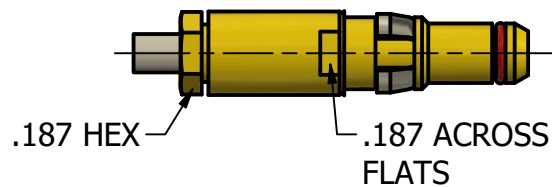

CAD DRAWING - NO MANUAL REVISIONS
filename:h:\Palco-Phoenix\Palco_A-B-C_Sizes_11-26-2018.rdw

WARNING - THIS DOCUMENT CONTAINS TECHNICAL DATA WHOSE EXPORT IS RESTRICTED BY THE ARMS EXPORT CONTROL ACT (TITLE 22, U.S.C., SEC 2751, ET. SEQ.) OR THE EXPORT ADMINISTRATION ACT OF 1979, AS AMENDED, TITLE 50, U.S.C., APP 2401 ET SEQ. VIOLATIONS OF THESE EXPORT LAWS ARE SUBJECT TO SEVERE CRIMINAL PENALTIES. DISSEMINATE IN ACCORDANCE WITH PROVISIONS OF DOD DIRECTIVE 5230.25.

MATERIAL:

REV.	DESCRIPTION	DATE	APPR.
G	PER ECN 13838	9/15/2020	SS
F	PER ECN 11007	06/24/11	JEM
E	PER ECN 10789	12/13/10	JEM
D	PER ECN 10298	04/21/10	JEM
C	PER ECN 9524	09/22/08	JEM
B	PER ECN 7570	08/06/04	JEM

UNLESS OTHERWISE SPECIFIED, PHOENIX WORKMANSHIP STANDARDS APPLY. DIMENSIONS IN INCHES OR (METRIC).
DO NOT SCALE PRINTS
TOLERANCES ARE:
FRACTIONS: ± 1/64
DECIMALS: .XX ± .01
XXX ± .003
ANGLES: ± 1/2°

32 ✓

THE INFORMATION DISCLOSED IN THIS DOCUMENT IS CONFIDENTIAL AND PROPRIETARY TO PHOENIX CO. INC. AND MAY NOT BE USED FOR MANUFACTURE OR ANY OTHER PURPOSE WITHOUT THE WRITTEN CONSENT OF THE PHOENIX CO. OF CHICAGO INC.

APPROVALS		DATE
DRAWN	EK	04/30/97
CHECKED	JEM	04/30/97
QA		
MFG		
ENGINEER	EY	04/30/97
APPROVED	JEM	04/30/97

The **PHOENIX** Company of Chicago, Inc.
22 GREAT HILL RD., NAUGATUCK, CT 06770
WWW.PHOENIXOFCHICAGO.COM

TITLE
CABLE ASSEMBLY PROCEDURE FOR PKZ, PLUG SOLDER/CLAMP

SIZE	FSCM	DWG NO	REV	PLATING OPT.
A	58167	26-003X-2670	G	
SCALE	F.S.R. #	SHEET 1 OF 1		