

CABLE ASSEMBLY PROCEDURE		PALEO CONNECTOR 22 GREAT HILL ROAD, NAUGATUCK, CT. 06770 PHONE: (203) 729-9090 FAX: (203) 723-1794	REV	DESCRIPTION	DATE	APPR
P/N	26-003X-0470		F	REL. ECN 3995	07/28/97	HN
PAGE 1 OF 1	DATE: 07/26/89		G	PER ECN 10500	08/05/10	JEM
DRAWN: YT	APPROVED: HN		H	PER ECN 10787	12/13/10	JEM
FOR USE WITH M17/151 CABLE			J	PER ECN 11002	06/22/11	JEM

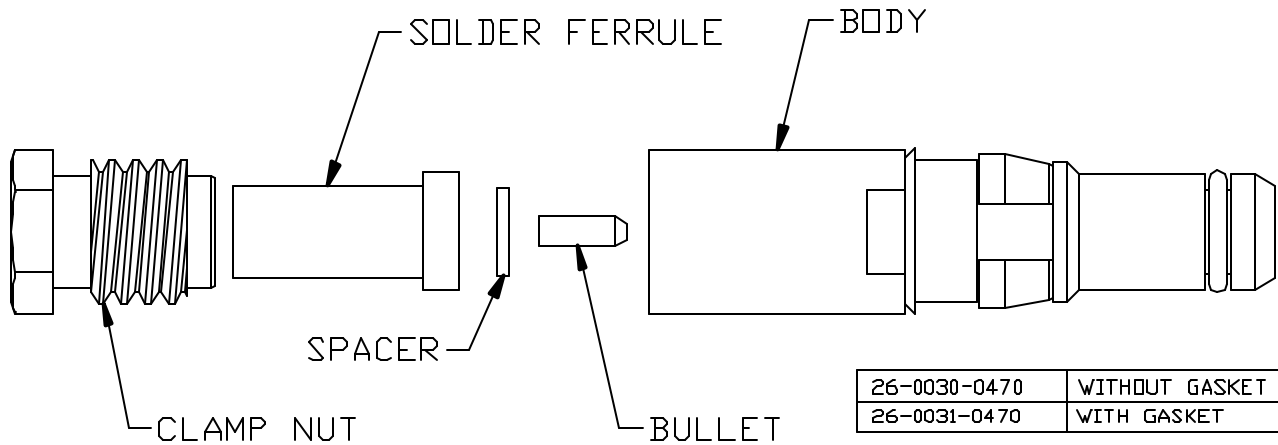

STEP 1
 TRIM CABLE TO DIMENSIONS SHOWN.
 TIN DIP CENTER CONDUCTOR ONLY.

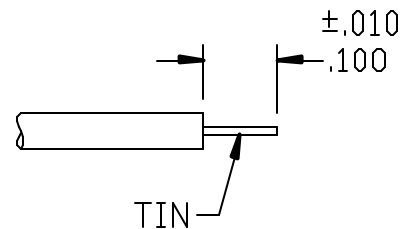

STEP 2
 SLIDE CLAMP NUT AND SOLDER FERRULE
 ONTO CABLE. SET COUNTERBORE IN
 SOLDER FERRULE FLUSH WITH CABLE
 AND SOLDER. CLEAN SOLDER JOINT.

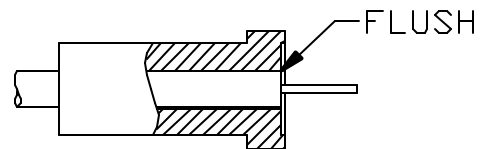

STEP 3
 SLIDE SPACER AND BULLET OVER CENTER
 CONDUCTOR OF CABLE. SOLDER BULLET
 TO CABLE. CLEAN SOLDER JOINT.

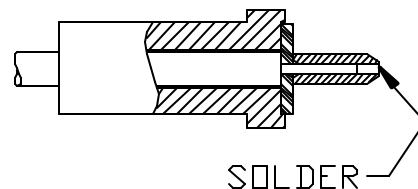

STEP 4
 INSERT CABLE ASSEMBLY INTO
 BODY AND TIGHTEN CLAMP
 NUT TO 90-100 IN-OZS.

