

4

3

2

1

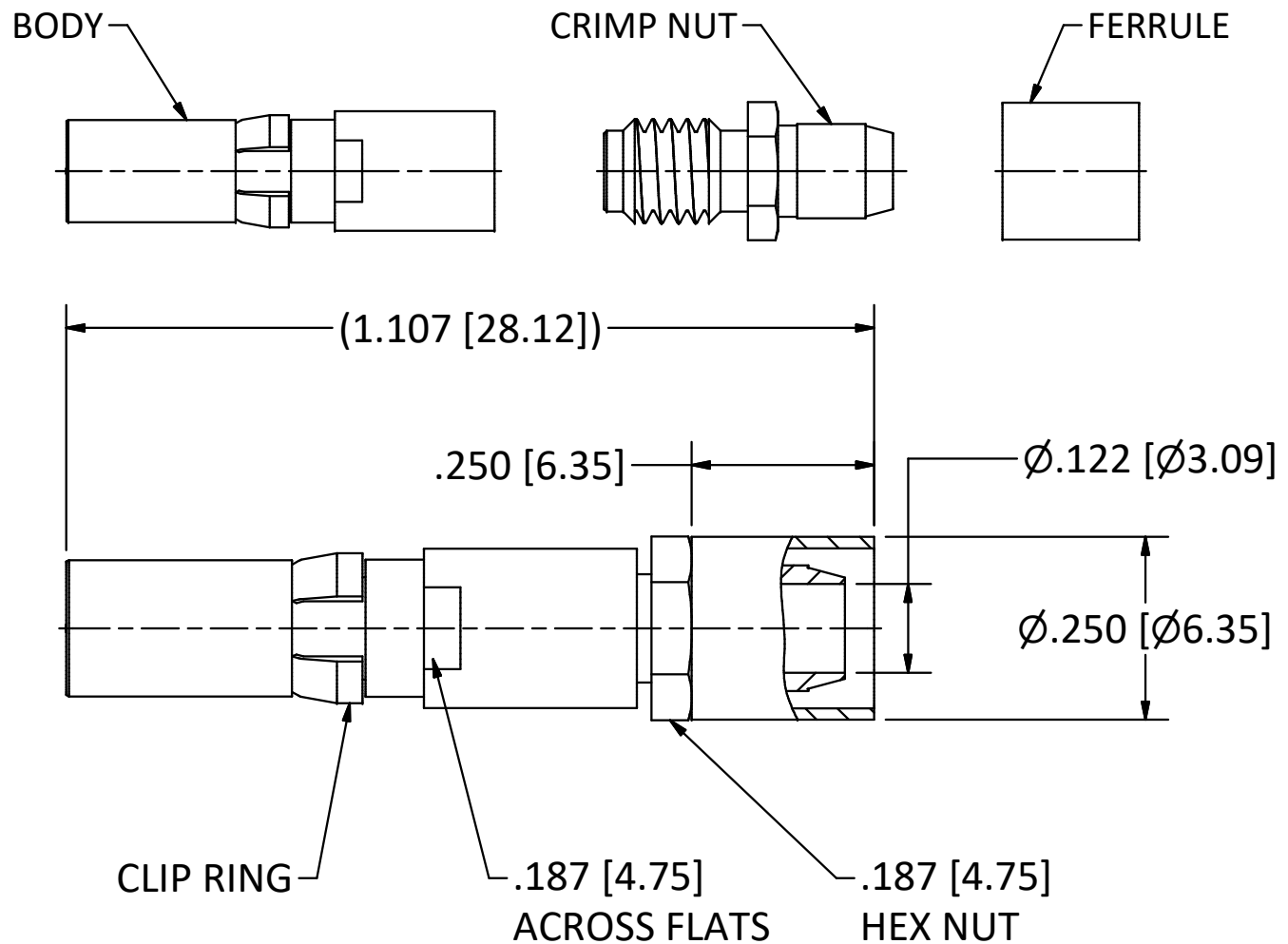

- NOTES:
1. SPECIFICATIONS PER IDS-26.
 2. CRIMP NUT AND FERRULE SHIPPED LOOSE.
 3. ACCOMMODATES RG-55, RG-142, OR RG-223 CABLE.
 4. CRIMP USING .213 HEX DIE (M22520/5-05).
- HOUSING:** D-SUBMINIATURE, SIZE 8 CAVITY.

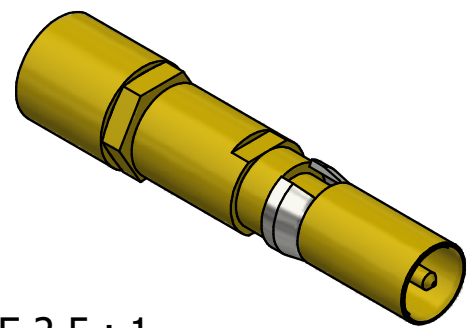

SCALE 2.5 : 1

<table border="1"> <tr><td>L</td><td>ECN 10295</td><td>4/21/10</td><td>JEM</td></tr> <tr><td>K</td><td>ECN 9699</td><td>12/9/08</td><td>JEM</td></tr> <tr><td>J</td><td>ECN 5724</td><td>12/22/00</td><td>HN</td></tr> <tr><td>I</td><td>ECN 4307</td><td>1/19/98</td><td>HN</td></tr> <tr><td>H</td><td>ECN 2893</td><td>5/2/95</td><td>HN</td></tr> <tr><td>REV.</td><td>DESCRIPTION</td><td>DATE</td><td>BY</td></tr> </table>				L	ECN 10295	4/21/10	JEM	K	ECN 9699	12/9/08	JEM	J	ECN 5724	12/22/00	HN	I	ECN 4307	1/19/98	HN	H	ECN 2893	5/2/95	HN	REV.	DESCRIPTION	DATE	BY	<p>This drawing embodies a proprietary design of The Phoenix Company of Chicago, Inc., Naugatuck, CT 06770. All design, manufacturing, reproduction, use, sale, and other rights regarding the same are expressly reserved. The information in this drawing may be covered completely or in part by patents and/or patents pending.</p>		<p>WARNING - THIS DOCUMENT CONTAINS TECHNICAL DATA WHOSE EXPORT IS RESTRICTED BY THE ARMS EXPORT CONTROL ACT (TITLE 22, U.S.C., SEC 2751, ET. SEQ.) OR THE EXPORT ADMINISTRATION ACT OF 1979, AS AMENDED, TITLE 50, U.S.C., APP 2401 ET SEQ. VIOLATIONS OF THESE EXPORT LAWS ARE SUBJECT TO SEVERE CRIMINAL PENALTIES. DISSEMINATE IN ACCORDANCE WITH PROVISIONS OF DOD DIRECTIVE 5230.25.</p>		<p>Filename: ver2\Autodesk Inventor Data Base\Assemblies\26 Series\26-1080-1201-CU.idw</p> <table border="1"> <tr><td>UNLESS OTHERWISE SPECIFIED, PHOENIX WORKMANSHIP STANDARDS APPLY DIMENSIONS IN INCHES OR (METRIC)</td><td>APPROVALS</td><td>DATE</td></tr> <tr><td>DO NOT SCALE PRINTS</td><td>DRAWN MY</td><td>11/23/1988</td></tr> <tr><td>TOLERANCES ARE: FRACTIONS: ± 1/64 DECIMALS: .XX ± .01 .XXX ± .003</td><td>CHECKED HN</td><td>11/23/1988</td></tr> <tr><td>ANGLES: ± 1/2°</td><td>QA</td><td></td></tr> <tr><td></td><td>MFG</td><td></td></tr> <tr><td></td><td>ENGINEER YT</td><td>11/23/1988</td></tr> <tr><td></td><td>APPROVED HN</td><td>11/23/1988</td></tr> </table>		UNLESS OTHERWISE SPECIFIED, PHOENIX WORKMANSHIP STANDARDS APPLY DIMENSIONS IN INCHES OR (METRIC)	APPROVALS	DATE	DO NOT SCALE PRINTS	DRAWN MY	11/23/1988	TOLERANCES ARE: FRACTIONS: ± 1/64 DECIMALS: .XX ± .01 .XXX ± .003	CHECKED HN	11/23/1988	ANGLES: ± 1/2°	QA			MFG			ENGINEER YT	11/23/1988		APPROVED HN	11/23/1988	<p>The PHOENIX Company of Chicago, Inc. 22 GREAT HILL RD., NAUGATUCK, CT 06770 WWW.PHOENIXOFCHICAGO.COM PHONE: (800) 323-9562 FAX:(630) 206-1801</p>		<p>TITLE PKZ® RECEPTACLE, CRIMP/CLAMP TERMINATION</p>	
L	ECN 10295	4/21/10	JEM																																																							
K	ECN 9699	12/9/08	JEM																																																							
J	ECN 5724	12/22/00	HN																																																							
I	ECN 4307	1/19/98	HN																																																							
H	ECN 2893	5/2/95	HN																																																							
REV.	DESCRIPTION	DATE	BY																																																							
UNLESS OTHERWISE SPECIFIED, PHOENIX WORKMANSHIP STANDARDS APPLY DIMENSIONS IN INCHES OR (METRIC)	APPROVALS	DATE																																																								
DO NOT SCALE PRINTS	DRAWN MY	11/23/1988																																																								
TOLERANCES ARE: FRACTIONS: ± 1/64 DECIMALS: .XX ± .01 .XXX ± .003	CHECKED HN	11/23/1988																																																								
ANGLES: ± 1/2°	QA																																																									
	MFG																																																									
	ENGINEER YT	11/23/1988																																																								
	APPROVED HN	11/23/1988																																																								
				SIZE B	FSCM 58167	DWG NO 26-1080-1201	REV L	PLATING OPT. A, B, C, D																																																		
				SCALE 2.5 : 1	F.S.R. #		SHEET 1 OF 1																																																			

4

3

2

1