

NOTES:

1. SPECIFICATIONS PER IDS-268L.
2. ACCOMMODATES RG-405 (.086 SEMI-RIGID) OR EQUIVALENT FLEXIBLE CABLE.
3. FREQUENCY: DC TO 18 GHz.
4. HOUSING: ARINC 600 RECEPTACLE CONNECTOR SHELL CONTAINING SIZE 16 CAVITY (REF: MIL-DTL-83527B).
5. **DOES NOT MATE WITH OTHER INDUSTRY-STANDARD SIZE 16 CONTACTS.**

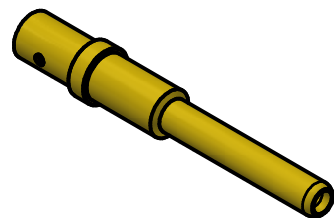

SCALE 2.5 : 1

<table border="1"> <tr> <td>A</td> <td>PER ECN 14385</td> <td>4/9/2024</td> <td>SPS</td> </tr> <tr> <th>REV.</th> <th>DESCRIPTION</th> <th>DATE</th> <th>APPROVAL</th> </tr> </table>				A	PER ECN 14385	4/9/2024	SPS	REV.	DESCRIPTION	DATE	APPROVAL	<p>This drawing embodies a proprietary design of The Phoenix Company of Chicago, Inc., Naugatuck, CT 06770. All design, manufacturing, reproduction, use, sale, and other rights regarding the same are expressly reserved. The information in this drawing may be covered completely or in part by patents and/or patents pending.</p>	<p>WARNING - THIS DOCUMENT CONTAINS TECHNICAL DATA WHOSE EXPORT IS RESTRICTED BY THE ARMS EXPORT CONTROL ACT (TITLE 22, U.S.C., SEC 2751, ET. SEQ.) OR THE EXPORT ADMINISTRATION ACT OF 1979, AS AMENDED, TITLE 50, U.S.C., APP 2401 ET SEQ. VIOLATIONS OF THESE EXPORT LAWS ARE SUBJECT TO SEVERE CRIMINAL PENALTIES. DISSEMINATE IN ACCORDANCE WITH PROVISIONS OF DOD DIRECTIVE 5230.25.</p>	<p>UNLESS OTHERWISE SPECIFIED, PHOENIX WORKMANSHIP STANDARDS APPLY DIMENSIONS IN INCHES OR (METRIC)</p>		<table border="1"> <tr> <th>APPROVALS</th> <th>DATE</th> </tr> <tr> <td>DRAWN RA</td> <td>4/9/2024</td> </tr> <tr> <td>CHECKED SPS</td> <td>4/9/2024</td> </tr> <tr> <td>QA</td> <td></td> </tr> <tr> <td>MFG</td> <td></td> </tr> <tr> <td>ENGINEER SPS</td> <td>4/9/2024</td> </tr> <tr> <td>APPROVED SPS</td> <td>4/9/2024</td> </tr> </table>		APPROVALS	DATE	DRAWN RA	4/9/2024	CHECKED SPS	4/9/2024	QA		MFG		ENGINEER SPS	4/9/2024	APPROVED SPS	4/9/2024	<p>The PHOENIX Company of Chicago, Inc. 22 GREAT HILL RD., NAUGATUCK, CT 06770 WWW.PHOENIXOFCHICAGO.COM PHONE: (800) 323-9562 FAX:(630) 206-1801</p>	
				A	PER ECN 14385	4/9/2024	SPS																										
REV.	DESCRIPTION	DATE	APPROVAL																														
APPROVALS	DATE																																
DRAWN RA	4/9/2024																																
CHECKED SPS	4/9/2024																																
QA																																	
MFG																																	
ENGINEER SPS	4/9/2024																																
APPROVED SPS	4/9/2024																																
<p>DO NOT SCALE PRINTS</p> <p>TOLERANCES ARE: FRACTIONS: ± 1/64 DECIMALS: .XX ± .01 .XXX ± .003 ANGLES: ± 1/2°</p>		<p>TITLE</p> <p>PkZ® PLUG, DIRECT SOLDER TERMINATION</p>		<table border="1"> <tr> <td>SIZE B</td> <td>FSCM 58167</td> <td>DWG NO 268L-0021-0860</td> <td>REV A</td> <td>PLATING OPT. A, C</td> </tr> </table>	SIZE B	FSCM 58167	DWG NO 268L-0021-0860	REV A	PLATING OPT. A, C																								
SIZE B	FSCM 58167	DWG NO 268L-0021-0860	REV A	PLATING OPT. A, C																													
				<p>SCALE 5 : 1</p>		<p>F.S.R. #</p>		<p>SHEET 1 OF 1</p>																									