

NOTES:

1. SPECIFICATIONS PER IDS-26.
 2. CLAMP NUT, FERRULE, BULLET, AND SPACER SHIPPED LOOSE.
 3. ACCOMMODATES RG-316 DOUBLE SHIELD (M17/152) CABLE.
- HOUSING:** DIN 41612, SIZE 8 CAVITY.

PART NUMBER	O-RING OPTIONS
26D-0030-2670	NONE
26D-0031-2670	ENVIRONMENTAL
26D-0033-2670	EMI SPRING
26D-0035-2670	GROUNDING RING

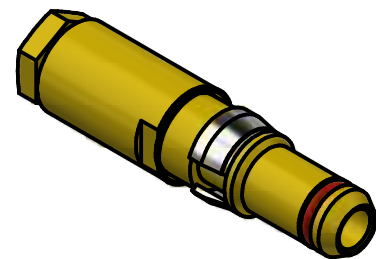

SCALE 2.5 : 1

REV	DESCRIPTION	DATE	BY
G	ECN 13810	7/9/20	JEM
F	ECN 10999	6/2/11	JEM
E	ECN 10697	11/10/10	JEM
D	ECN 10102	12/03/09	JEM
C	ECN 7560	7/28/04	JEM
B	ECN 3380	4/22/96	HN

THE INFORMATION AND DESIGNS DISCLOSED IN THIS DOCUMENT ARE CONFIDENTIAL AND/OR PROPRIETARY TO THE PHOENIX COMPANY OF CHICAGO INC. AND MAY NOT BE USED FOR MANUFACTURING, REPRODUCED, DISCLOSED TO OTHERS OR FOR ANY OTHER PURPOSE WITHOUT THE EXPRESS WRITTEN CONSENT OF THE PHOENIX COMPANY OF CHICAGO INC.

WARNING - THIS DOCUMENT CONTAINS TECHNICAL DATA WHOSE EXPORT IS RESTRICTED BY THE ARMS EXPORT CONTROL ACT (TITLE 22, U.S.C., SEC 2751, ET. SEQ.) OR THE EXPORT ADMINISTRATION ACT OF 1979, AS AMENDED, TITLE 50, U.S.C., APP 2401 ET SEQ. VIOLATIONS OF THESE EXPORT LAWS ARE SUBJECT TO SEVERE CRIMINAL PENALTIES. DISSEMINATE IN ACCORDANCE WITH PROVISIONS OF DOD DIRECTIVE 5230.25.

Filename: ver2\Autodesk Inventor Data Base\Assemblies\26 Series\26D-003X-2670-CU.idw

UNLESS OTHERWISE SPECIFIED, PHOENIX WORKMANSHIP STANDARDS APPLY DIMENSIONS IN INCHES OR (METRIC)

DO NOT SCALE PRINTS
TOLERANCES ARE:
FRACTIONS: ± 1/64
DECIMALS: .XX ± .01
.XXX ± .003
ANGLES: ± 1/2°

32√

APPROVALS	DATE
DRAWN EK	11/08/95
CHECKED JEM	11/08/95
QA	
MFG	
ENGINEER JSV	11/08/95
APPROVED JEM	11/08/95

The PHOENIX Company of Chicago, Inc.

22 GREAT HILL RD., NAUGATUCK, CT 06770
WWW.PHOENIXOFCHICAGO.COM
PHONE: (800) 323-9562 FAX:(630) 206-1801

TITLE
PKZ® PLUG, SOLDER/CLAMP TERMINATION

SIZE	FSCM	DWG NO	REV	PLATING OPT.
B	58167	26D-003X-2670	G	A, B, C, D

SCALE F.S.R. # SHEET 1 OF 1