

CABLE ASSEMBLY PROCEDURE	
P/N	26D-003X-0470
PAGE 1 OF 1	DATE: 07/28/97
DRAWN: JEM	APPROVED: HN
FOR USE WITH M17/151 CABLE	

PALEO
CONNECTOR

22 GREAT HILL ROAD, NAUGATUCK, CT. 06770
PHONE: (203) 729-9090 FAX: (203) 723-1794

REV	DESCRIPTION	DATE	APPR
B	REL. ECN 3995	07/28/97	HN
C	PER ECN 11013	06/27/11	JEM

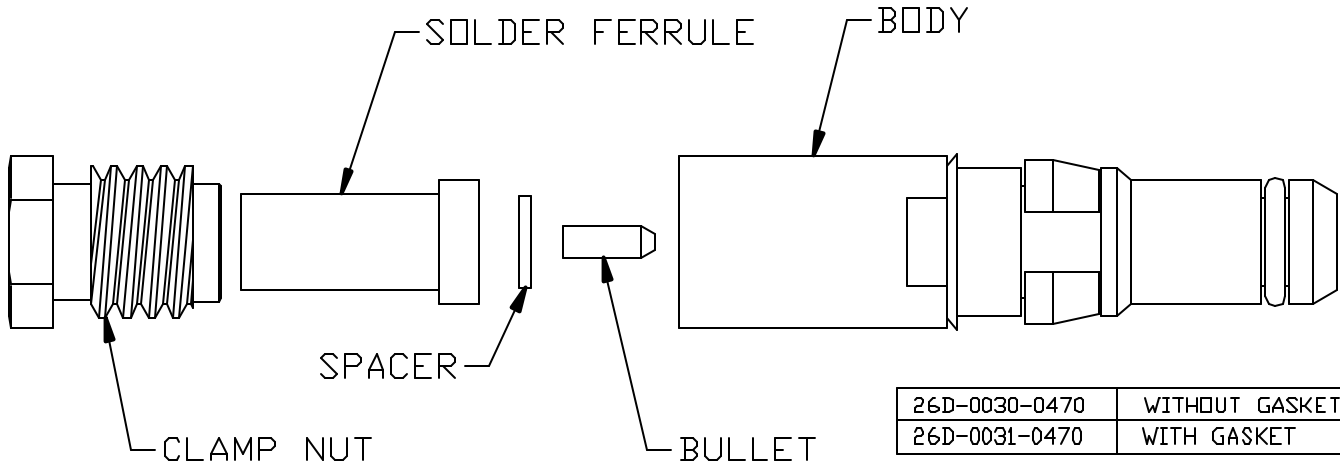

STEP 1
TRIM CABLE TO DIMENSIONS SHOWN.
TIN DIP CENTER CONDUCTOR ONLY.

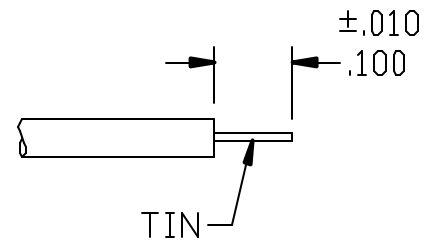

STEP 2
SLIDE CLAMP NUT AND SOLDER FERRULE
ONTO CABLE. SET COUNTERBORE IN
SOLDER FERRULE FLUSH WITH CABLE
AND SOLDER. CLEAN SOLDER JOINT.

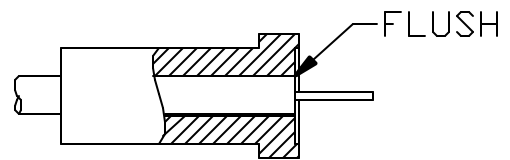

STEP 3
SLIDE SPACER AND BULLET OVER CENTER
CONDUCTOR OF CABLE. SOLDER BULLET
TO CABLE. CLEAN SOLDER JOINT.

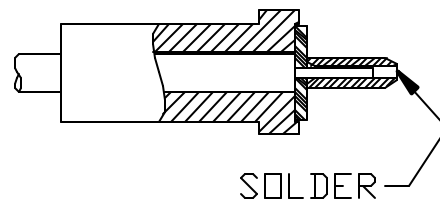

STEP 4
INSERT CABLE ASSEMBLY INTO
BODY AND TIGHTEN CLAMP
NUT TO 90-100 IN-OZS.

