

2

1

## Cable Assembly Procedure

### Step 1

Trim cable to dimensions shown point center conductor. (.315 dimensions for jacketed cables only).

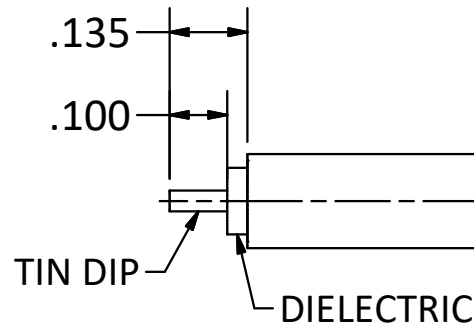

### Step 2

Slide contact onto center conductor. Butt against dielectric. Heat contact and reflow solder. Use solder paste if necessary. Clean.

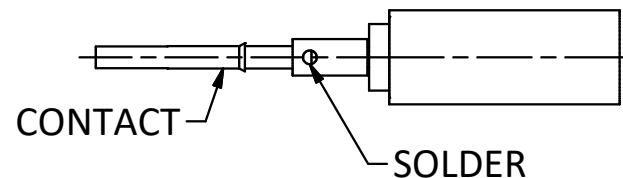

### Step 3

Slide cable into body and solder to outer cable jacket. Clean.

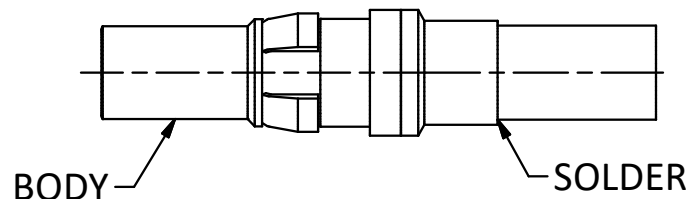

WARNING - THIS DOCUMENT CONTAINS TECHNICAL DATA WHOSE EXPORT IS RESTRICTED BY THE ARMS EXPORT CONTROL ACT (TITLE 22, U.S.C., SEC 2751, ET. SEQ.) OR THE EXPORT ADMINISTRATION ACT OF 1979, AS AMENDED, TITLE 50, U.S.C., APP 2401 ET SEQ. VIOLATIONS OF THESE EXPORT LAWS ARE SUBJECT TO SEVERE CRIMINAL PENALTIES. DISSEMINATE IN ACCORDANCE WITH PROVISIONS OF DOD DIRECTIVE 5230.25.

Filename: \Autodesk Inventor Data Base\Assemblies\78 Series\78-1080-0670-CU-Layout for C Sized Drawing.idw

UNLESS OTHERWISE SPECIFIED,  
PHOENIX WORKMANSHIP STANDARDS APPLY  
DIMENSIONS IN INCHES OR (METRIC)

DO NOT SCALE PRINTS

TOLERANCES ARE:

FRACTIONS:  $\pm 1/64$

DECIMALS:  $\pm .01$

XXX  $\pm .003$

ANGLES:  $\pm 1/2^\circ$

THE INFORMATION AND DESIGNS  
DISCLOSED IN THIS DOCUMENT ARE  
CONFIDENTIAL AND/OR  
PROPRIETARY TO THE PHOENIX  
COMPANY OF CHICAGO INC. AND  
MAY NOT BE USED FOR  
MANUFACTURING, REPRODUCED,  
DISCLOSED TO OTHERS OR FOR ANY  
OTHER PURPOSE WITHOUT THE  
EXPRESS WRITTEN CONSENT OF THE  
PHOENIX COMPANY OF CHICAGO  
INC.

APPROVALS	DATE
DRAWN CA	12/30/20
CHECKED JEM	12/30/20
QA	
MFG	
ENGINEER JSV	7/16/96
APPROVED JEM	7/16/96

**The PHOENIX Company of Chicago, Inc.**

22 GREAT HILL RD., NAUGATUCK, CT 06770  
WWW.PHOENIXOFCHICAGO.COM

PHONE: (800) 323-9562 FAX:(630) 206-1801

TITLE  
**STRAIGHT RECEPTACLE, DIRECT  
SOLDER TERMINATION**

REV.	DESCRIPTION	DATE	BY	SIZE	FSCM	DWG NO	REV	PLATING OPT.
C	ECN 13788	6/17/20	JEM	A	58167	28-1020-1410	C	
B	ECN7715	12/8/4	JEM					
A	ECN 3489	7/16/96	HN					
				SCALE	F.S.R. #	SHEET 1 OF 1		

2

1