

CABLE ASSEMBLY PROCEDURE		PALEO CONNECTOR 22 GREAT HILL ROAD, NAUGATUCK, CT. 06770 PHONE: (203) 729-9090 FAX: (203) 723-1794	REV	DESCRIPTION	DATE	APPR
P/N	33-2200-0860		J	PER ECN 8110	07/25/05	JEM
PAGE 1 OF 2	DATE: 10/26/98		K	PER ECN 8559	06/20/06	JEM
DRAWN: YS	APPROVED: JEM		L	PER ECN 9176	12/5/07	JEM
FOR USE WITH RG-405 CABLE			M	PER ECN 9242	1/23/08	JEM

FOR USE WITH RG-405 CABLE

STEP 1.
TRIM CABLE TO DIMENSION SHOWN.
TIN DIP CENTER CONDUCTOR.

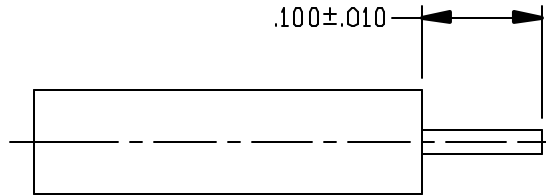

STEP 2.
INSERT CABLE INTO CONNECTOR.
SOLDER CENTER CONDUCTOR TO CENTER CONTACT.
SOLDER CABLE JACKET TO CONNECTOR BODY.
CLEAN OFF ANY FLUX.

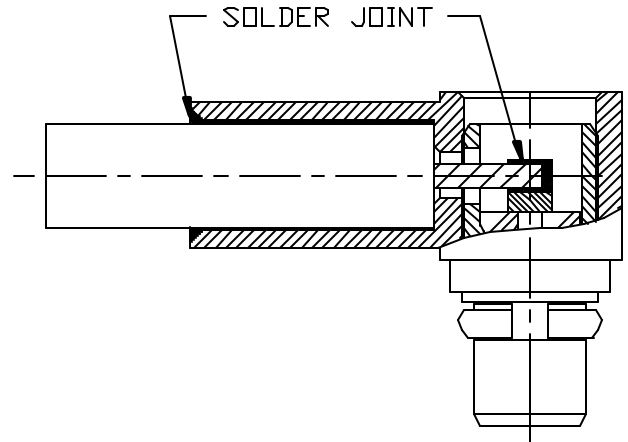

STEP 3.
PRESS CAP INTO BACK HOLE UNTIL FLUSH.

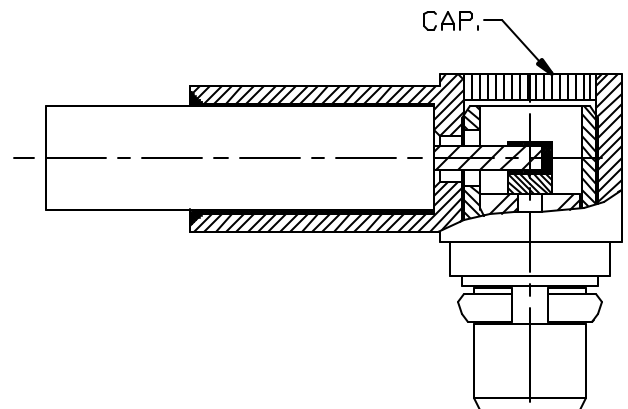

CABLE ASSEMBLY PROCEDURE	
P/N	33-2200-0860
PAGE 2 OF 2	DATE: 10/26/98
DRAWN: YS	APPROVED: JEM
FOR USE WITH T-FLEX 405 CABLE	

PALEO
CONNECTOR

22 GREAT HILL ROAD, NAUGATUCK, CT. 06770
PHONE: (203) 729-9090 FAX: (203) 723-1794

REV	DESCRIPTION	DATE	APPR
J	PER ECN 8110	07/25/05	JEM
K	PER ECN 8559	06/20/06	JEM
L	PER ECN 9176	12/5/07	JEM
M	PER ECN 9242	1/23/08	JEM

FOR USE WITH T-FLEX 405 CABLE

STEP 1.
TRIM CABLE TO DIMENSION SHOWN.
TIN DIP BRAID.

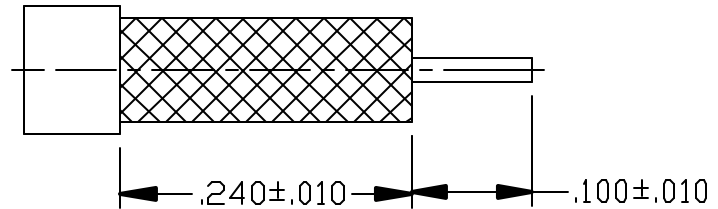

STEP 2.
INSERT CABLE INTO CONNECTOR.
SOLDER CENTER CONDUCTOR TO CENTER CONTACT.
SOLDER CABLE JACKET TO CONNECTOR BODY.
CLEAN OFF ANY FLUX.

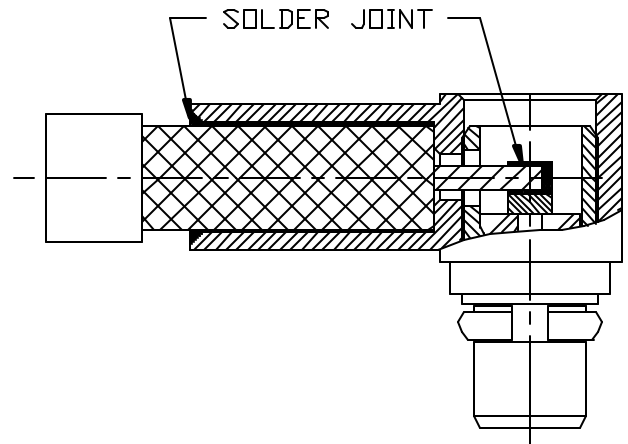

STEP 3.
PRESS CAP INTO BACK HOLE UNTIL FLUSH.

