

CABLE ASSEMBLY PROCEDURE
P/N 56-0080-0001
PAGE 1 OF 1 DATE: 02/16/04
DRAWN: EK APPROVED: HN
USE WITH #16; 18; 20 AWG WIRES

PALCO
CONNECTOR
22 GREAT HILL ROAD, NAUGATUCK, CT. 06770
PHONE: (203) 729-9090 FAX: (203) 723-1794

REV	DESCRIPTION	DATE	APPR
B	PER ECN 7219	02/16/04	HN
C	PER ECN 12609	08/30/17	JEM

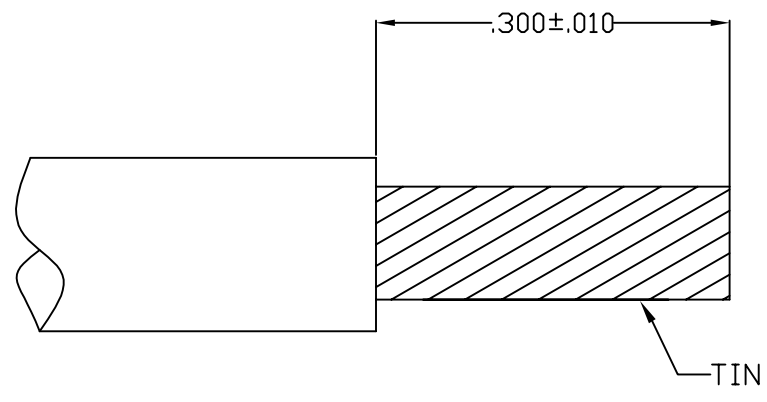

STEP 1
TRIM WIRE TO DIMENSIONS SHOWN.
TIN CENTER CONDUCTOR.

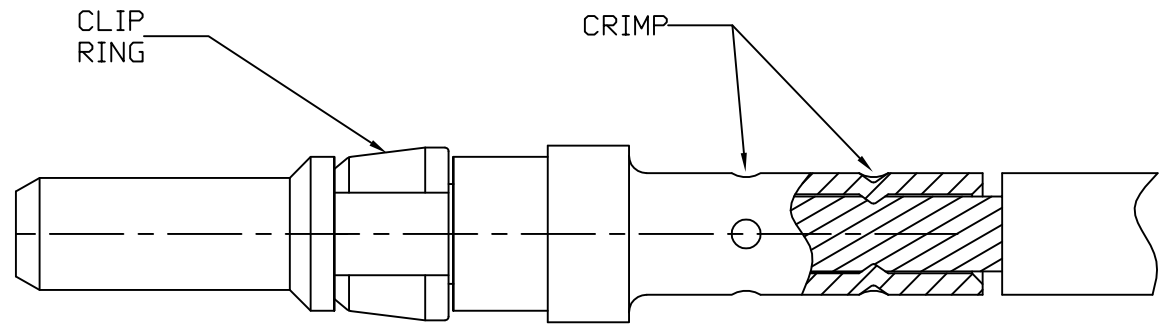

STEP 2
CRIMP WITH DANIELS CRIMP TOOL FT8,
PALCO'S POSITIONER T0624 USING SETTING #8 FOR #16 AWG WIRE,
SETTING #6 FOR #18 AWG WIRE AND
SETTING #4 FOR #20 AWG WIRE.