

CABLE ASSEMBLY PROCEDURE	
P/N	56-0202-0670
PAGE 1 OF 1	DATE: 01/17/13
DRAWN: JEM	APPROVED: JEM
FOR USE WITH RG-316 CABLE	

PALEO
CONNECTOR

22 GREAT HILL ROAD, NAUGATUCK, CT. 06770
PHONE: (203) 729-9090 FAX: (203) 723-1794

REV	DESCRIPTION	DATE	APPR
01	PRELIMINARY	11/06/12	JEM
A	PER ECN 11552	01/17/13	JEM
B	PER ECN 11644	01/17/13	JEM
C	PER ECN 11724	07/18/13	JEM

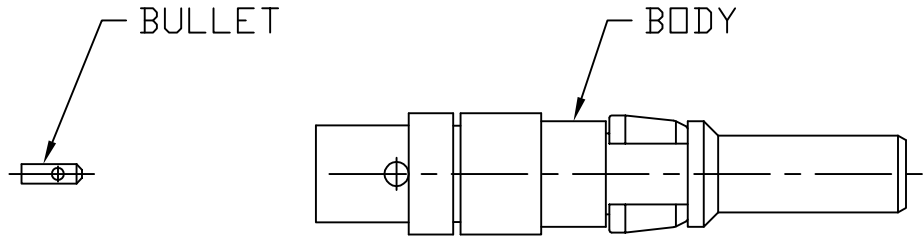

STEP 1
DIP END OF CABLE INTO FLUX AND THEN TIP DIP CABLE TO DIMENSIONS SHOWN USING KESTER 63/37 SOLDER @ 500°F FOR SIX SECONDS MAX.

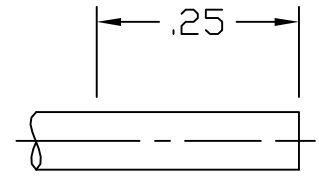

STEP 2
TRIM CABLE TO DIMENSIONS SHOWN. TIN CENTER CONDUCTOR.

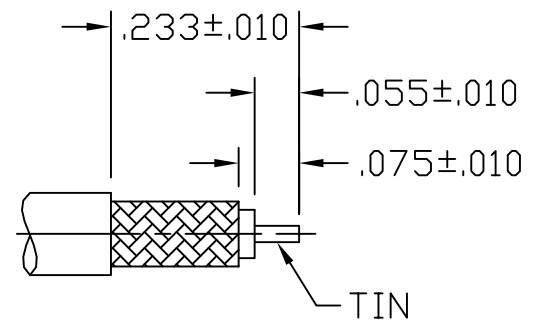

STEP 3
SLIDE BULLET ONTO CENTER CONDUCTOR AS SHOWN. SOLDER BULLET TO CENTER CONDUCTOR. CLEAN SOLDER JOINT.

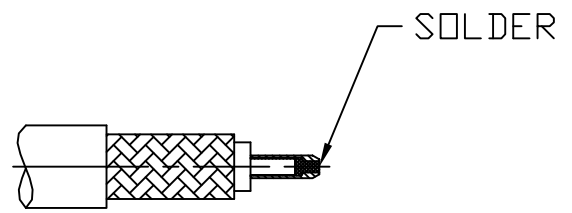

STEP 4
INSERT ABOVE CABLE INTO CONNECTOR BODY UNTIL CABLE BOTTOMS. SOLDER BODY TO CABLE. CLEAN SOLDER JOINT.

