

REVISIONS

| REV | DESCRIPTION | DATE | APPROVED |
|-----|----------------|-----------|----------|
| C | PER ECN #11648 | 04/22/13 | JEM |
| D | PER ECN #11730 | 07/22/13 | JEM |
| E | PER ECN #12035 | 11/11/14 | JEM |
| F | PER ECN #13239 | 2/18/2019 | JEM |

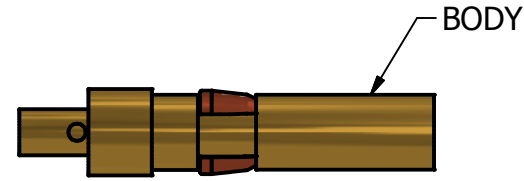

STEP 1
 DIP END OF CABLE INTO FLUX AND THEN TIP DIP CABLE TO DIMENSIONS SHOWN USING KESTER 63/37 SOLDER @500°F FOR SIX SECONDS MAX.

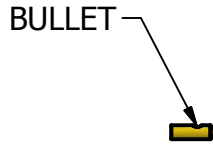
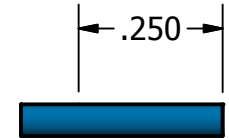

STEP 2
 TRIM CABLE TO DIMENSIONS SHOWN. TIN CENTER CONDUCTOR.

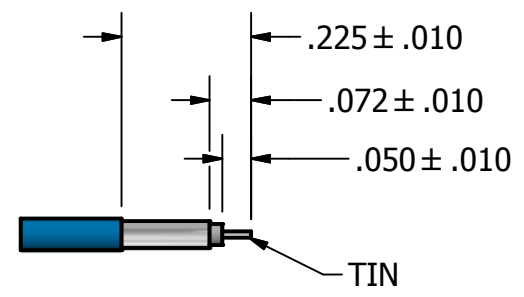

STEP 3
 SLIDE BULLET ONTO CENTER CONDUCTOR AS SHOWN. SOLDER BULLET TO CENTER CONDUCTOR. CLEAN SOLDER JOINT.

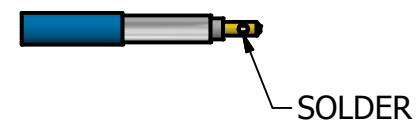

STEP 4
 INSERT ABOVE CABLE INTO CONNECTOR BODY UNTIL CABLE BOTTOMS. SOLDER BODY TO CABLE. CLEAN SOLDER JOINT.

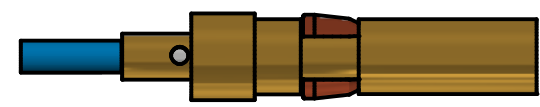

UNLESS OTHERWISE SPECIFIED DIMENSIONS ARE IN INCHES TOLERANCES ARE:
 FRACTIONS DECIMALS ANGLES
 ±1/64 .XX ±.01 ±1/2
 .XXX ±.003

THE INFORMATION DISCLOSED IN THIS DOCUMENT IS CONFIDENTIAL AND PROPRIETARY TO PHOENIX CO. INC. AND MAY NOT BE USED FOR MANUFACTURE OR ANY OTHER PURPOSE WITHOUT THE WRITTEN CONSENT OF PHOENIX CO. INC.

DO NOT SCALE DRAWING

| | |
|--------------|----------|
| CONTRACT NO. | |
| APPROVALS | DATE |
| DRAWN SST | 02/18/19 |
| CHECKED JEM | 02/18/19 |
| ISSUED | |

The PHOENIX Company of Chicago™
 22 GREAT HILL RD., NAUGATUCK, CT 06770
 WWW.PHOENIXOFCHICAGO.COM

SIZE 12 PkZ
RECEPTACLE, DIRECT SOLDER

| | | | |
|----------|--------------|-------------------------|----------|
| SIZE | FSCM NO. | DWG. NO. | REV. |
| A | 58167 | 56-1202-0400 CAP | F |

SCALE SHEET 1 OF 1