

2

1

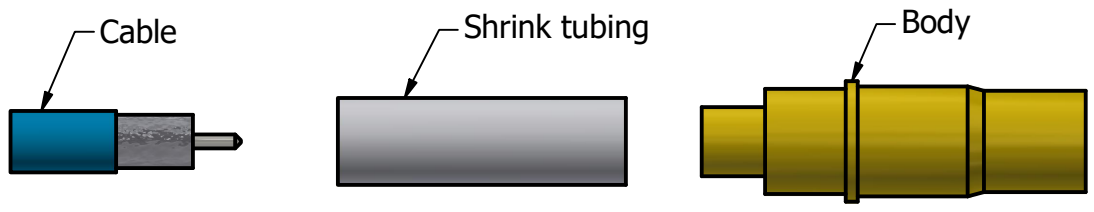

**STEP 1**

Flux end of Cable. Stick Cable into Solder Pot to dimension shown, for 3 seconds maximum.

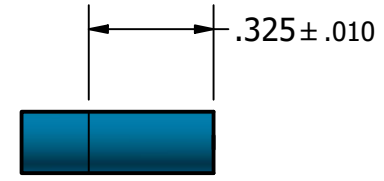

**STEP 2**

Trim Cable to dimensions shown. Point Center Conductor. Slide Shrink Tubing over Cable.

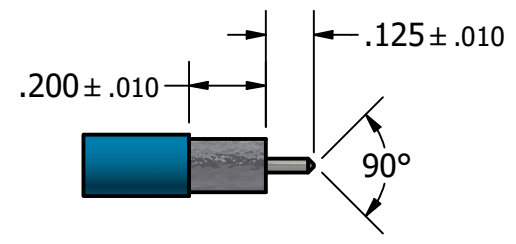

**STEP 3**

Insert Cable into back of Body and solder Braid to Connector as shown. Clean Solder joint.

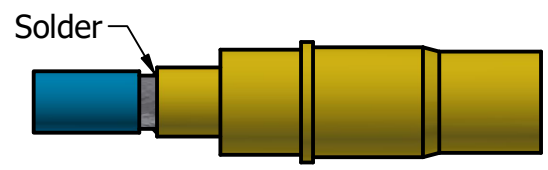

**STEP 4**

Slide Shrink Tubing into position over Body and shrink in place.

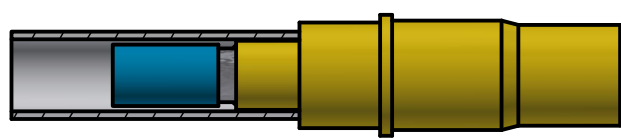

WARNING - THIS DOCUMENT CONTAINS TECHNICAL DATA WHOSE EXPORT IS RESTRICTED BY THE ARMS EXPORT CONTROL ACT (TITLE 22, U.S.C., SEC 2751, ET. SEQ.) OR THE EXPORT ADMINISTRATION ACT OF 1979, AS AMENDED, TITLE 50, U.S.C., APP 2401 ET SEQ. VIOLATIONS OF THESE EXPORT LAWS ARE SUBJECT TO SEVERE CRIMINAL PENALTIES. DISSEMINATE IN ACCORDANCE WITH PROVISIONS OF DOD DIRECTIVE 5230.25.

The information and designs disclosed in this document are confidential and/or proprietary to The Phoenix Company of Chicago, Inc. and may not be used for manufacturing, reproduced, disclosed to others, or used for any other purpose without express written consent of The Phoenix Company of Chicago, Inc.

**MATERIAL:**

| E    | PER ECN 14233 | RA | 10/8/2024 | DW    | 11/26/2024 |
|------|---------------|----|-----------|-------|------------|
| D    | PER ECN 13522 |    |           | JEM   | 10/3/2019  |
| C    | PER ECN 9686  |    |           | JEM   | 12/9/2008  |
| B    | PER ECN 5534  |    |           | JEM   | 7/18/2000  |
| A    | PER ECN 4696  |    |           | HN    | 9/18/1998  |
| REV. | DESCRIPTION   | BY | DATE      | APPR. | DATE       |

UNLESS OTHERWISE SPECIFIED, PHOENIX WORKMANSHIP STANDARDS APPLY. DIMENSIONS IN INCHES OR [METRIC]

DO NOT SCALE PRINTS

TOLERANCES ARE:  
FRACTIONS:  $\pm 1/64$   
DECIMALS:  $.XX \pm .01$   
 $.XXX \pm .003$

ANGLES:  $\pm 1/2^\circ$

| APPROVALS      | DATE      |
|----------------|-----------|
| DRAWN<br>JEM   | 9/18/1998 |
| CHECKED        |           |
| QA             |           |
| MFG            |           |
| ENGINEER       |           |
| APPROVED<br>HN | 9/18/1998 |

**The PHOENIX Company of Chicago, Inc.**  
 22 GREAT HILL RD., NAUGATUCK, CT 06770  
 WWW.PHOENIXOFCHICAGO.COM  
 PHONE: (800) 323-9562 FAX: (630) 206-1801

TITLE  
**CABLE ASSEMBLY PROCEDURE FOR 78-1020-1413**

|                  |               |                        |          |              |
|------------------|---------------|------------------------|----------|--------------|
| SIZE<br><b>A</b> | FSCM<br>58167 | DWG NO<br>78-1020-1413 | REV<br>E | PLATING OPT. |
| SCALE<br>2:1     | F.S.R. #      | SHEET 1 OF 1           |          |              |

2

1