

NOTES:

1. DESIGN AND INTERFACE PER IDS-78 & 05.
2. ELECTRICALS:
 - 2.1 IMPEDANCE: 50 OHMS
 - 2.2 FREQUENCY: DC TO 32 GHz.
 - 2.3 VSWR: 1.30:1 TO 26.5 GHz
1.35:1 TO 32 GHz.

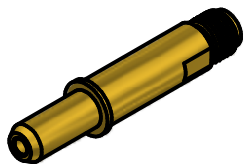

MATERIAL:				<small>UNLESS OTHERWISE SPECIFIED, PALCO WORKMANSHIP STANDARDS APPLY. DIMENSIONS IN INCHES OR (METRIC).</small> <small>DO NOT SCALE PRINTS</small> <small>TOLERANCES ARE:</small> FRACTIONS: ± 1/64 DECIMALS: .XX ± .01 .XXX ± .005 ANGLES: ± 1/2°	<table border="1"> <thead> <tr> <th>APPROVALS</th> <th>DATE</th> </tr> </thead> <tbody> <tr> <td>DRAWN JEM</td> <td>02/23/18</td> </tr> <tr> <td>CHECKED R.M.B.</td> <td>02/23/2018</td> </tr> <tr> <td>QA</td> <td></td> </tr> <tr> <td>MFG</td> <td></td> </tr> <tr> <td>ENGINEER JEMaturo</td> <td>02/23/18</td> </tr> <tr> <td>APPROVED R.M.B.</td> <td>02/23/2018</td> </tr> </tbody> </table>		APPROVALS	DATE	DRAWN JEM	02/23/18	CHECKED R.M.B.	02/23/2018	QA		MFG		ENGINEER JEMaturo	02/23/18	APPROVED R.M.B.	02/23/2018	<p>22 GREAT HILL RD., NAUGATUCK, CT 06770</p>	
APPROVALS	DATE																					
DRAWN JEM	02/23/18																					
CHECKED R.M.B.	02/23/2018																					
QA																						
MFG																						
ENGINEER JEMaturo	02/23/18																					
APPROVED R.M.B.	02/23/2018																					
<table border="1"> <tr> <td>A</td> <td>REL. PER ECN 12792</td> <td>2/23/2018</td> <td>RMB</td> </tr> <tr> <th>REV.</th> <th>DESCRIPTION</th> <th>DATE</th> <th>APPR.</th> </tr> </table>				A	REL. PER ECN 12792	2/23/2018	RMB	REV.	DESCRIPTION	DATE	APPR.	TITLE SIZE 8, 38999 PkZ PLUG TO 3.5mm RECEPTACLE ADAPTER		SIZE A	FSCM 58167	DWG NO 7805-0100-01	REV A	PLATING OPT. G				
A	REL. PER ECN 12792	2/23/2018	RMB																			
REV.	DESCRIPTION	DATE	APPR.																			
				SCALE 1		F.S.R. #		SHEET 1 OF 1														