

- NOTES:
1. SPECIFICATIONS PER IDS-785.
  2. BULLET, CRIMP NUT, FERRULE, AND SPACER SHIPPED LOOSE.
  3. ACCOMMODATES RG-179 CABLE.
  4. CRIMP USING .128 HEX DIE (M22520/5-03).
- HOUSING:** MIL-C-38999 SERIES I, III, & IV AND MIGHTY MOUSE SERIES 80, SIZE 8 CAVITY.

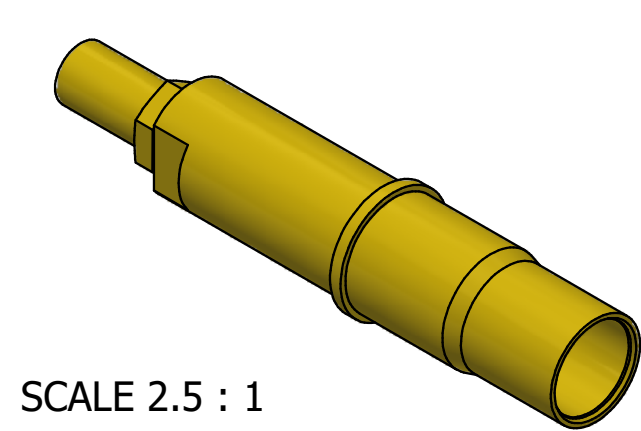

SCALE 2.5 : 1

				THE INFORMATION AND DESIGNS DISCLOSED IN THIS DOCUMENT ARE CONFIDENTIAL AND/OR PROPRIETARY TO THE PHOENIX COMPANY OF CHICAGO INC. AND MAY NOT BE USED FOR MANUFACTURING, REPRODUCED, DISCLOSED TO OTHERS OR FOR ANY OTHER PURPOSE WITHOUT THE EXPRESS WRITTEN CONSENT OF THE PHOENIX COMPANY OF CHICAGO INC.	WARNING - THIS DOCUMENT CONTAINS TECHNICAL DATA WHOSE EXPORT IS RESTRICTED BY THE ARMS EXPORT CONTROL ACT (TITLE 22, U.S.C., SEC 2751, ET. SEQ.) OR THE EXPORT ADMINISTRATION ACT OF 1979, AS AMENDED, TITLE 50, U.S.C., APP 2401 ET SEQ. VIOLATIONS OF THESE EXPORT LAWS ARE SUBJECT TO SEVERE CRIMINAL PENALTIES. DISSEMINATE IN ACCORDANCE WITH PROVISIONS OF DOD DIRECTIVE 5230.25.	Filename: \\Autodesk Inventor Data Base\\Assemblies\\78 Series\\78-1080-0670-CU-Layout for C Sized Drawing.idw		<div>The <b>PHOENIX</b> Company of Chicago, Inc.</div> <div>22 GREAT HILL RD., NAUGATUCK, CT 06770 WWW.PHOENIXOFCHICAGO.COM</div> <div>PHONE: (800) 323-9562 FAX:(630) 206-1801</div>					
						UNLESS OTHERWISE SPECIFIED, PHOENIX WORKMANSHIP STANDARDS APPLY DIMENSIONS IN INCHES OR (METRIC)		APPROVALS	DATE	TITLE <div>75 OHM, PkZ® RECEPTACLE, CRIMP/CLAMP TERMINATION</div>			
DO NOT SCALE PRINTS  TOLERANCES ARE: FRACTIONS: ± 1/64 DECIMALS: .XX ± .01 .XXX ± .003 ANGLES: ± 1/2°  32√		DRAWN SS	2/16/18										
		CHECKED JEM	2/16/18										
		QA											
		MFG											
		ENGINEER SPS	2/16/18	SIZE B	FSCM 58167	DWG NO <b>785-1080-0670</b>		REV A	PLATING OPT. A, B, C, D				
		APPROVED JEM	2/16/18	SCALE		F.S.R. #		SHEET 1 OF 1					
A	REL PER ECN 12788	2/16/18	JEM										
REV	DESCRIPTION	DATE	BY										