

- NOTES:
- HOUSING SUB-ASSEMBLY MARKED AS SHOWN; "PRC532DX2XANONE YYWWPC", "1", "11", "43", & "53".
 - MATERIALS:
BLACK DELRIN (ACETAL, COPOLYMER): HOUSING, INNER & OUTER 2-PIECE STRAIN RELIEF.
STAINLESS STEEL, PASSIVATED: JACKSCREW SHAFTS & HEADS, INSERTS, SCREWS, WASHERS & PINS.
BERYLLIUM, GOLD PLATED: GUIDE PINS
 - OPERATING TEMPERATURE: -67°F TO +257°F (-55°C TO +125°C).
 - DIMENSIONS ARE FOR REFERENCE ONLY, UNLESS OTHERWISE SPECIFIED.
 - ABOVE REQUIREMENTS DO NOT INCLUDE CABLE ASSEMBLIES.
 - DESIGNED FOR CABLES WITH DIAMETERS FROM $\phi.104$ TO $\phi.058$.
 - PARTS WILL BE RECEIVED LOOSE.
 - ASSEMBLE PER HARNESS ASSEMBLY PROCEDURE FOR PRC532DX-HAP.

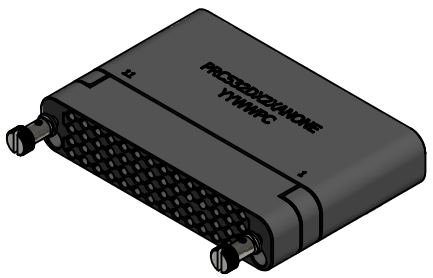

| <p>WARNING - THIS DOCUMENT CONTAINS TECHNICAL DATA WHOSE EXPORT IS RESTRICTED BY THE ARMS EXPORT CONTROL ACT (TITLE 22, U.S.C., SEC 2751, ET. SEQ.) OR THE EXPORT ADMINISTRATION ACT OF 1979, AS AMENDED, TITLE 50, U.S.C., APP 2401 ET SEQ. VIOLATIONS OF THESE EXPORT LAWS ARE SUBJECT TO SEVERE CRIMINAL PENALTIES. DISSEMINATE IN ACCORDANCE WITH PROVISIONS OF DOD DIRECTIVE 5230.25.</p> <p>THE INFORMATION AND DESIGNS DISCLOSED IN THIS DOCUMENT ARE CONFIDENTIAL AND/OR PROPRIETARY TO THE PHOENIX COMPANY OF CHICAGO INC. AND MAY NOT BE USED FOR MANUFACTURING, REPRODUCED, DISCLOSED TO OTHERS OR FOR ANY OTHER PURPOSE WITHOUT THE EXPRESS WRITTEN CONSENT OF THE PHOENIX COMPANY OF CHICAGO INC.</p> | | | | <p>File name: ver2\Autodesk Inventor Data Base\Assemblies\Phoenix Assemblies\PRC\PRC532DX2XANONE-CUJ.idw</p> | | <p>The PHOENIX Company of Chicago, Inc.</p> <p>22 GREAT HILL RD., NAUGATUCK, CT 06770 WWW.PHOENIXOFCHICAGO.COM PHONE: (800) 323-9562 FAX:(630) 206-1801</p> | | | | | | | | | | | | | | | | | | | | | |
|---|-------------|------------------------|-------------|---|----|---|-----------|-----------|------|--------------|-------------|-----------|-----|---|--|------|------|-----------------|----------|--------------|---|--|------------------------|---|--|-------------------------------------|--|
| | | | | <p>UNLESS OTHERWISE SPECIFIED, PALCO WORKMANSHIP STANDARDS APPLY DIMENSIONS IN INCHES OR (METRIC)</p> <p>DO NOT SCALE PRINTS</p> <p>TOLERANCES ARE: FRACTIONS: $\pm 1/64$ DECIMALS: .XX $\pm .01$.XXX $\pm .003$ ANGLES: $\pm 1/2$</p> | | <table border="1"> <thead> <tr> <th>APPROVALS</th> <th>DATE</th> </tr> </thead> <tbody> <tr> <td>DRAWN BGW</td> <td>10/6/2020</td> </tr> <tr> <td>CHECKED</td> <td></td> </tr> <tr> <td>QA</td> <td></td> </tr> <tr> <td>MFG</td> <td></td> </tr> <tr> <td>ENGINEER BGW</td> <td>3/3/2021</td> </tr> <tr> <td>APPROVED</td> <td></td> </tr> </tbody> </table> | | APPROVALS | DATE | DRAWN BGW | 10/6/2020 | CHECKED | | QA | | MFG | | ENGINEER BGW | 3/3/2021 | APPROVED | | <p>TITLE 53 POSITION, PRC PkZ® PLUG HOUSING, WITH 2-PIECE STRAIN RELIEF, CABLES $\phi.104$ - $\phi.058$</p> | | | | | |
| APPROVALS | DATE | | | | | | | | | | | | | | | | | | | | | | | | | | |
| DRAWN BGW | 10/6/2020 | | | | | | | | | | | | | | | | | | | | | | | | | | |
| CHECKED | | | | | | | | | | | | | | | | | | | | | | | | | | | |
| QA | | | | | | | | | | | | | | | | | | | | | | | | | | | |
| MFG | | | | | | | | | | | | | | | | | | | | | | | | | | | |
| ENGINEER BGW | 3/3/2021 | | | | | | | | | | | | | | | | | | | | | | | | | | |
| APPROVED | | | | | | | | | | | | | | | | | | | | | | | | | | | |
| <table border="1"> <thead> <tr> <th>REV.</th> <th>DESCRIPTION</th> <th>DATE</th> <th>BY</th> </tr> </thead> <tbody> <tr> <td>A</td> <td>ECN 13842</td> <td>3/3/2021</td> <td>BGW</td> </tr> <tr> <td>01</td> <td>PRELIMINARY</td> <td>10/6/2020</td> <td>BGW</td> </tr> </tbody> </table> | | REV. | DESCRIPTION | DATE | BY | A | ECN 13842 | 3/3/2021 | BGW | 01 | PRELIMINARY | 10/6/2020 | BGW | <table border="1"> <thead> <tr> <th>SIZE</th> <th>FSCM</th> <th>DWG NO</th> <th>REV</th> <th>PLATING OPT.</th> </tr> </thead> <tbody> <tr> <td>C</td> <td>58167</td> <td>PRC532DX2XANONE</td> <td>A</td> <td></td> </tr> </tbody> </table> | | SIZE | FSCM | DWG NO | REV | PLATING OPT. | C | 58167 | PRC532DX2XANONE | A | | <p>SCALE: F.S.R. # SHEET 1 OF 1</p> | |
| REV. | DESCRIPTION | DATE | BY | | | | | | | | | | | | | | | | | | | | | | | | |
| A | ECN 13842 | 3/3/2021 | BGW | | | | | | | | | | | | | | | | | | | | | | | | |
| 01 | PRELIMINARY | 10/6/2020 | BGW | | | | | | | | | | | | | | | | | | | | | | | | |
| SIZE | FSCM | DWG NO | REV | PLATING OPT. | | | | | | | | | | | | | | | | | | | | | | | |
| C | 58167 | PRC532DX2XANONE | A | | | | | | | | | | | | | | | | | | | | | | | | |