

NOTES:

1. PROTECTIVE CAP, NOT SHOWN.
2. FOR USE WITH STABILIZING RING P/N 56-00097.

PROCEDURES

A. INSERTION:

1. SLIDE STABILIZING RING OVER SIZE 12 PkZ® PLUG.
2. PRESS FLUSH TO HOUSING USING SIDE A.

B. REMOVAL:

1. INSERT TINES ON SIDE B INTO SLOTS OF STABILIZING RING, UNTIL TINES SNAP INTO POSITION.
2. REMOVE RING BY PULLING TOOL BACK.

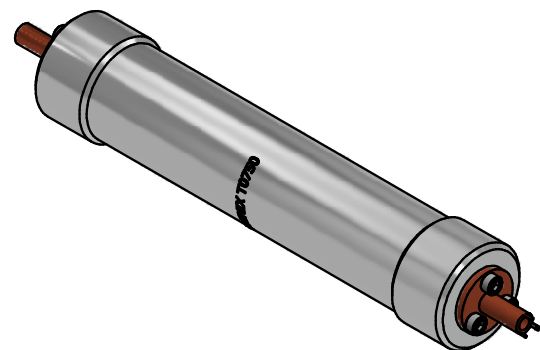

REV.	DESCRIPTION	DATE	BY
D	PER ECN 14058	8/25/2021	BGW
C	PER ECN 11789	11/06/2013	JEM
B	PER ECN 11757	08/20/2013	JEM
A	PEL PER ECN11043	07/20/2011	MS

THE INFORMATION AND DESIGNS DISCLOSED IN THIS DOCUMENT ARE CONFIDENTIAL AND/OR PROPRIETARY TO THE PHOENIX COMPANY OF CHICAGO INC. AND MAY NOT BE USED FOR MANUFACTURING, REPRODUCED, DISCLOSED TO OTHERS OR FOR ANY OTHER PURPOSE WITHOUT THE EXPRESS WRITTEN CONSENT OF THE PHOENIX COMPANY OF CHICAGO INC.

WARNING - THIS DOCUMENT CONTAINS TECHNICAL DATA WHOSE EXPORT IS RESTRICTED BY THE ARMS EXPORT CONTROL ACT (TITLE 22, U.S.C., SEC 2751, ET. SEQ.) OR THE EXPORT ADMINISTRATION ACT OF 1979, AS AMENDED, TITLE 50, U.S.C., APP 2401 ET SEQ. VIOLATIONS OF THESE EXPORT LAWS ARE SUBJECT TO SEVERE CRIMINAL PENALTIES. DISSEMINATE IN ACCORDANCE WITH PROVISIONS OF DOD DIRECTIVE 5230.25.

Filename: ver2\Autodesk Inventor Data Base\Tooling\T0750-CU.idw

UNLESS OTHERWISE SPECIFIED, PHOENIX WORKMANSHIP STANDARDS APPLY DIMENSIONS IN INCHES OR (METRIC)

DO NOT SCALE PRINTS

TOLERANCES ARE:
FRACTIONS: ± 1/64
DECIMALS: .XX ± .01
.XXX ± .003

ANGLES: ± 1/2°

32√

APPROVALS	DATE
DRAWN JEM	08/25/2021
CHECKED	
QA	
MFG	
ENGINEER JEMaturo	07/30/10
APPROVED MS	07/30/10

The PHOENIX Company of Chicago, Inc.

22 GREAT HILL RD., NAUGATUCK, CT 06770
WWW.PHOENIXOFCHICAGO.COM
PHONE: (800) 323-9562 FAX:(630) 206-1801

TITLE
INSERTION/REMOVAL TOOL FOR SIZE 12 STABILIZING RING

SIZE	FSCM	DWG NO	REV	PLATING OPT.
B	58167	T0750	D	
SCALE	F.S.R. # 11515		SHEET 1 OF 1	